

pomdi

PERFIL/PROFILE:
Z0-40

NOMBRE/NAME:
FLAT POLISH-40

Z0-40

EXC

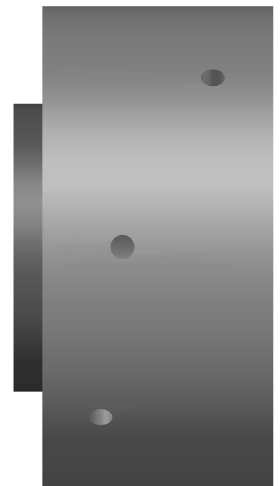
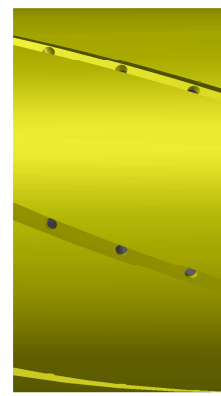
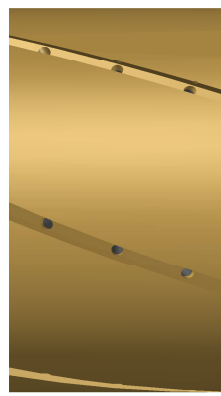
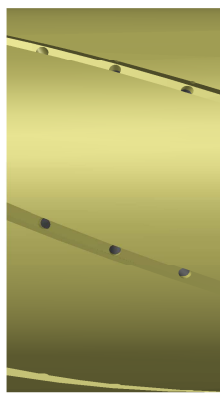
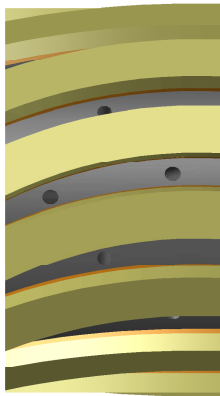
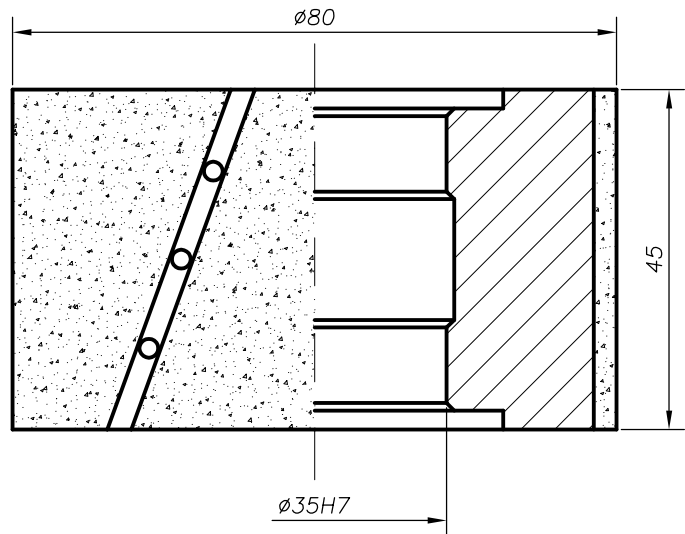

	POS.	CODIGO/CODE	DESCRIPCIÓN/DESCRIPTION
METALICA METALLIC	1	S-740272	CNC 35 D80 ZACK (Z0 40) M P.1 SEG EXC
	2	S-743437	CNC 35 D80 ZACK (Z0 40) M P.2 EXC
	3	S-743438	CNC 35 D80 ZACK (Z0 40) M P.3 EXC
	4	S-743439	CNC 35 D80 ZACK (Z0 40) M P.4 EXC
DIAMLOX	5	S-870123	CNC 35 D100 ZACK (Z0 40) DIAMLOX 1200